

October 12, 1968.

Dear Friend:

On regard to the early life of Wheeling, I will start with the mail carrier. This man a Civil War veteran returned from the war in the fall and worked for my father husking corn. Guess for what? Six cents a day and board unbelievable. The country was poor and so were the settlers. This man by the name of Glousie was appointed Mail Carrier and also was a shoe maker by trade. His daily travels to walk carrying the mail sack to Wheeling Depot, then returning with mail in a sack for the town of Wheeling. He also walked a mile east to Sanders road then north to a grocery store owned by Buberst who operated the Post Office known as North Northfield.

This was his daily Route rain or shine.
 Wheeling had two Doctors, Dr Moffit and Dr. Rice -
 two black smiths shops - William Metz and
 Riswick, a wagon maker by Louis Fisher a
 hardware store by Fassbender and Arnold
 established in 1880, a Brewery owned and operated
 by Perolat, a milk and cheese factory built by
 Henry Boelmer and operated by him for many years.
 Christ Stryker owned a covered wagon and
 traveled the country side selling groceries
 and meat from the wagon. Wheeling had a
 Veterinarian Dr Schneider a harness maker by
 Reinhold Schneider who also repaired bicycles
 when bicycles became the mode of travel.
 Huntzinger owned a grocery store and sold to
 John Schminke. The red brick building a land
 mark in wheeling also a grocery store owned by
 Sigwalt and later operated by Bollenbach and

No. 3.

finally by Ed Wellfin.

Mr. Moss owned a tavern and rooming house who also was a dealer in horses.

The Methodist established a church for a number of years and when they closed the doors the building was purchased by Baehm who owned the Union Hotel and this building was used as a dance hall for many years.

Milwaukee Avenue was just a graded street through town with ditches on either side.

Wheeling had no water or sewer system.

The village officials finally decided to purchase a water pump for fire protection for the residents of Wheeling. This pump was mounted on four wheels and was pulled about by hand however it required six men to operate, 3 men on either side. Wheeling was fortunate, no fire or threat of fire for many years.

In order to test this pump the village officials built a four walled make shift house north of the cemetery, and set fire to this building, where they got the water I do not know I was not that fortunate to see this building burn.

On a special occasion I saw six men parading on Milwaukee Avenue through town, two pulling this pump the other men walking on either side, I knew all six men at that time one man I remember his name was Kaiser who owned and operated the meat market, building for many years. The village was not without a Marshall, this office was held by Henry Hipp. At one time the gossip I heard in town was this fact that Jacob Schwingel a resident of Wheeling was the only registered Democrat voter in town. One Fall the men gathered in town to stage a parade for President of the United States, every parader was given a kerosene torch with wood

CERTIFICATE

No. 7918 }

THE UNITED STATES OF AMERICA.

To all to whom these presents shall come, Greeting:

Whereas

Joseph Wilkins of Cook County Illinois

has deposited in the GENERAL LAND OFFICE of the United States, a Certificate of the Register of the Land Office at *Chicago* whereby it appears that full payment has been made by the said *Joseph Wilkins* according

to the provisions of the act of Congress of the 24th of April, 1820, entitled "An Act making further provision for the sale of the Public Lands," for *the South East quarter and the East half of the South West quarter of Section Three, in Township Forty two North, of Range Eleven East, in the District of Lands subject to sale at Chicago Illinois, containing Five hundred and Forty acres.*

according to the official plat of the survey of the said Lands, returned to the General Land Office by the SUPERIOR GENERAL, which said tract has been purchased by the said *Joseph Wilkins*.

NOW KNOW YE, That the

United States of America, in consideration of the Premises, and in conformity with the several acts of Congress, in such case made and provided, HAVE GIVEN AND GRANTED, and by these presents DO GIVE AND GRANT, unto the said *Joseph Wilkins*

and to *his* heirs, the said tract above described: TO HAVE AND TO HOLD the same, together with all the rights, privileges, immunities, and appurtenances of whatsoever nature, thereunto belonging, unto the said *Joseph Wilkins* and to *his* heirs and assigns forever.

IN TESTIMONY WHEREOF, I, *John Tyler*

PRESIDENT OF THE UNITED STATES OF AMERICA, have caused these letters to be made PATENT, and the SEAL of the GENERAL LAND OFFICE to be hereunto affixed.

GIVEN under my hand at the CITY OF WASHINGTON, the *twelfth* day of *March* in the year of our Lord one

thousand eight hundred and *forty three* and of the INDEPENDENCE OF THE UNITED STATES the *thirty second*

By the President:

John Tyler

By

William Anderson

Sec'y.

RECORDED, VOL. 16 PAGE 331.

RECORDER OF THE GENERAL LAND OFFICE.

Post Office Department,

TOPOGRAPHER'S OFFICE,

Washington, D. C., Dec 1, 1893.

Sir:

To enable the Topographer of this Department to determine, with as much accuracy as possible, the relative positions of Post Offices, so that they may be correctly delineated on its maps, the Postmaster General requests you to fill up the spaces below, and the diagram on fourth page, returning the same, verified by your signature and dated, under cover to this Office.

Respectfully, &c.,

A. von Haacke

Topographer P. O. Dept.

TO POSTMASTER AT

Wheeling,
Cook County
Illinois

The (P. O. Dept.) name of my Office is

*Its local name is

It is situated in the _____ quarter of Section No. _____, in Township _____ (north or south), Range _____ (east or west), County _____ of _____, State of _____

The name of the most prominent river near it is

The name of the nearest creek is

This Office is _____ miles from said river, on the _____ side of it, and is _____ miles from said nearest creek, on the _____ side of it.

The name of the nearest Office on route No. _____ is _____, and its distance is _____ miles, by the traveled road, in a _____ direction from this, my Office.

The name of the nearest Office, on the same route, on the other side, is _____ and its distance is _____ miles in a _____ direction from this, my Office.

The name of the nearest Office off the route is _____, and its distance by the most direct road is _____ miles in a _____ direction from this, my Office.

This Office is at a distance of _____ from the _____ Station of the Northern Pacific Railroad, on the _____ side of the railroad.

State, under this, the names of other Offices near your Office, in different directions from it, and their distances from it by the most direct roads.

*If the town, village, or site of the Post Office be known by another name than that of the Post Office, state that other name here, that it may be identified on the map of the State (or Territory).

☒ A diagram of the township and sections (or, where the land is not so divided, a sketch map), showing the precise location of your Office, together with the adjoining Post Offices, towns, or villages, the roads, railroads, and larger streams or creeks, in addition to the above, will be useful, and is desired.—(See diagram blank accompanying this, to be filled up.)

(Signature of Postmaster.)

(Date.)

Diagram showing the site of the Post Office
in Township 4.2, Range 1.1 of 3.1 Principal
Meridian, County of _____, State
of _____, with the adjacent Townships and Post
Offices.

It is requested that the exact site of the proposed, or existing Post Office, as also the roads to the adjoining Offices, and the larger streams or rivers, be marked on this diagram, to be returned as soon as possible to the Post Office Department. If on, or near a railroad, mark the railroad and adjacent Station accurately.

(NORTH.)

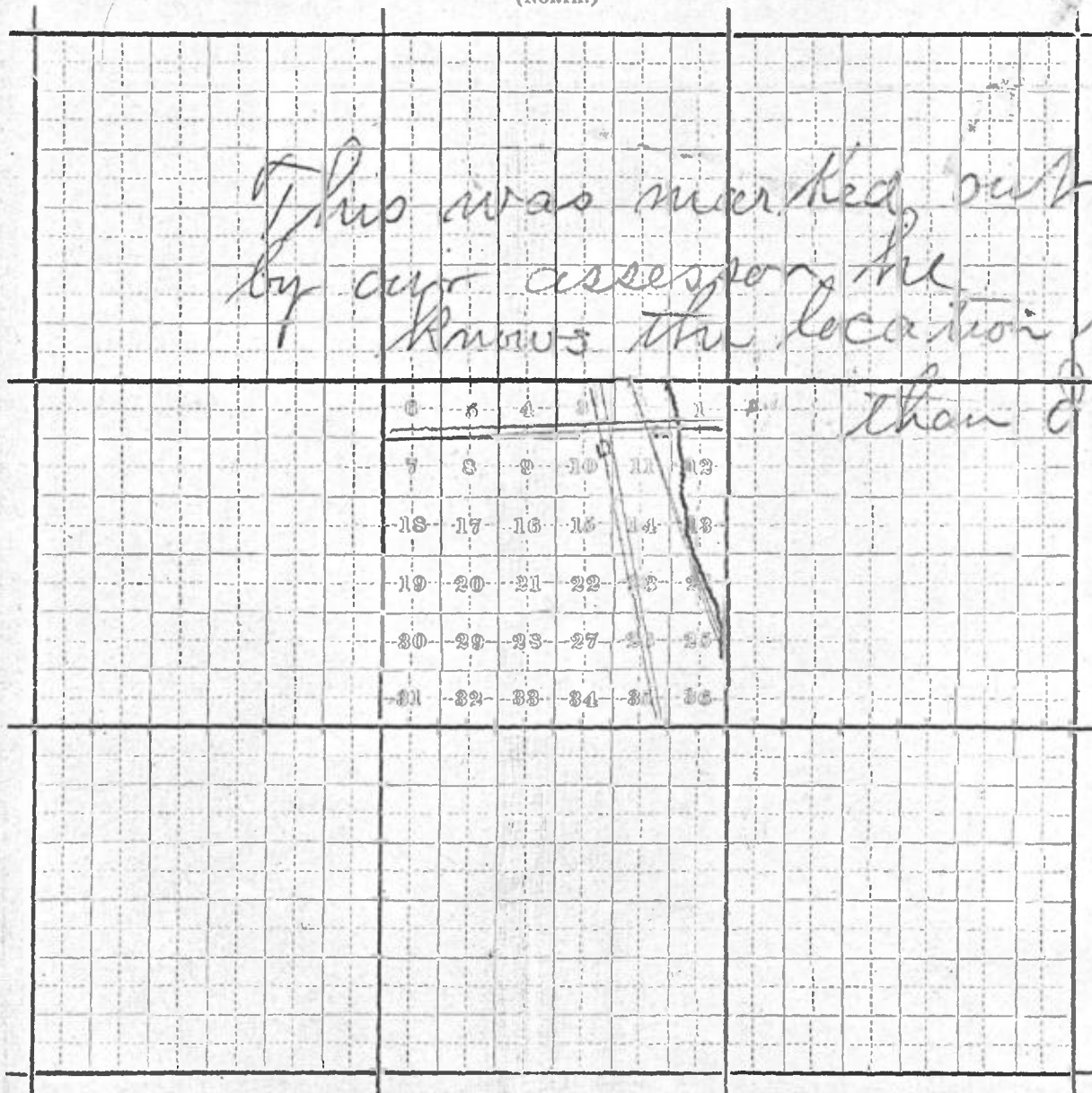

Scale $\frac{1}{4}$ inch to the mile.

(SOUTH.)

5-2342

2. Request.

(101.)

Post Office Department,

TOPOGRAPHER'S OFFICE,

Washington, D. C. Dec 22, 1893

Sir:

To enable the Topographer of this Department to determine, with as much accuracy as possible, the relative positions of Post Offices, so that they may be correctly delineated on its maps, the Postmaster General requests you to fill up the spaces below, and the diagram on fourth page, returning the same, verified by your signature and dated, under cover to this Office.

Respectfully, &c.,

A. von Haake

Topographer P. O. Dept.

TO POSTMASTER AT

Wheeling,

Cook County,

Illinois.

The (P. O. Dept.) name of my Office is

Wheeling

*Its local name is

It is situated in the South East quarter of Section No. 2, in Township

42 (north or south), Range 11 (east or west), County

of Cook, State of Illinois

The name of the most prominent river near it is

Deep River

The name of the nearest creek is

Buffalo Creek

This Office is 1/4 miles from said river, on the West side of it, and is 2 miles from said nearest creek, on the South side of it.

The name of the nearest Office on route No. 355-73 is North Northfield and its distance is 1 1/4 miles, by the traveled road, in a East direction from this, my Office.

The name of the nearest Office, on the same route, on the other side, is and its distance is miles in a direction from this, my Office.

The name of the nearest Office off the route is Buffalo Grove, and its distance by the most direct road is 3 miles in a North West direction from this, my Office.

This Office is at a distance of one 1/2 from the Wheeling Station of the Wisconsin Central Railroad, on the West side of the railroad.

State, under this, the names of other Offices near your Office, in different directions from it, and their distances from it by the most direct roads.

* If the town, village, or site of the Post Office be known by another name than that of the Post Office, state that other name here, that it may be identified on the map of the State (or Territory).

A diagram of the township and sections (or, where the land is not so divided, a sketch map), showing the precise location of your Office, together with the adjoining Post Offices, towns, or villages, the roads, railroads, and larger streams or creeks, in addition to the above, will be useful, and is desired.—(See diagram blank accompanying this, to be filled up.)

(Signature of Postmaster.)

(Date.)

Dec 28 93

Diagram showing the site of the Wheeling Post Office
 in Township 42, Range 6 of Principal
Meridian, County of Ill, State
 of Ill, with the adjacent Townships and Post
 Off.

It
 roads to
 be return
 mark th

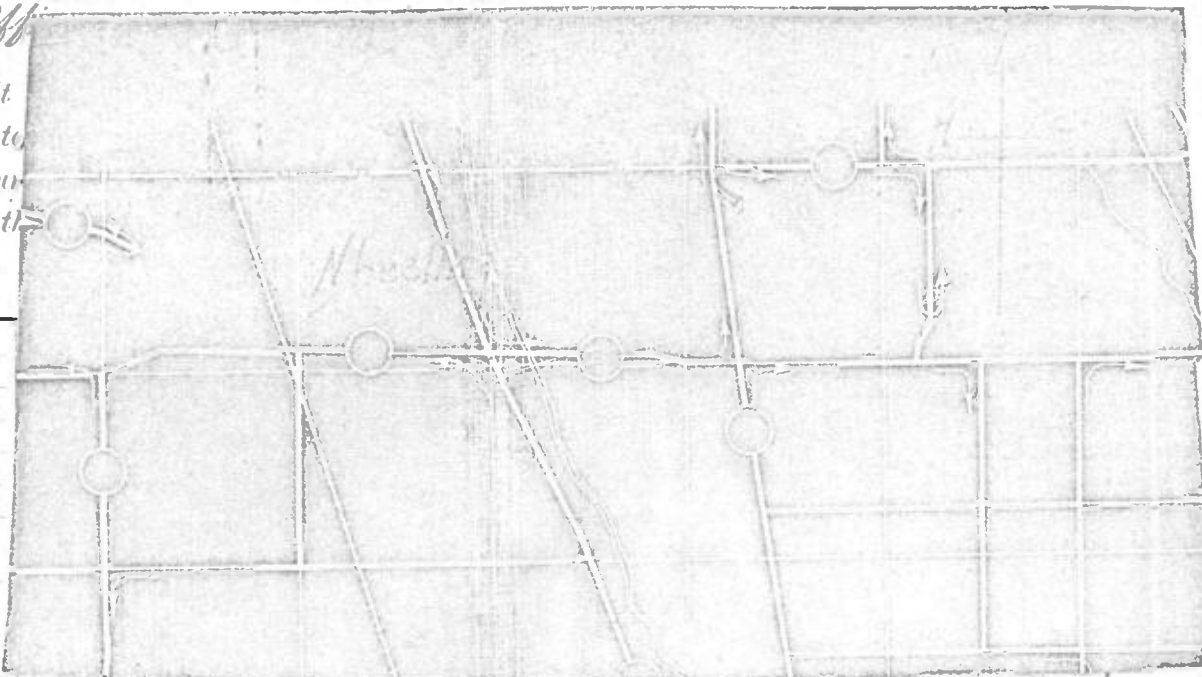

Tp 42
 N.

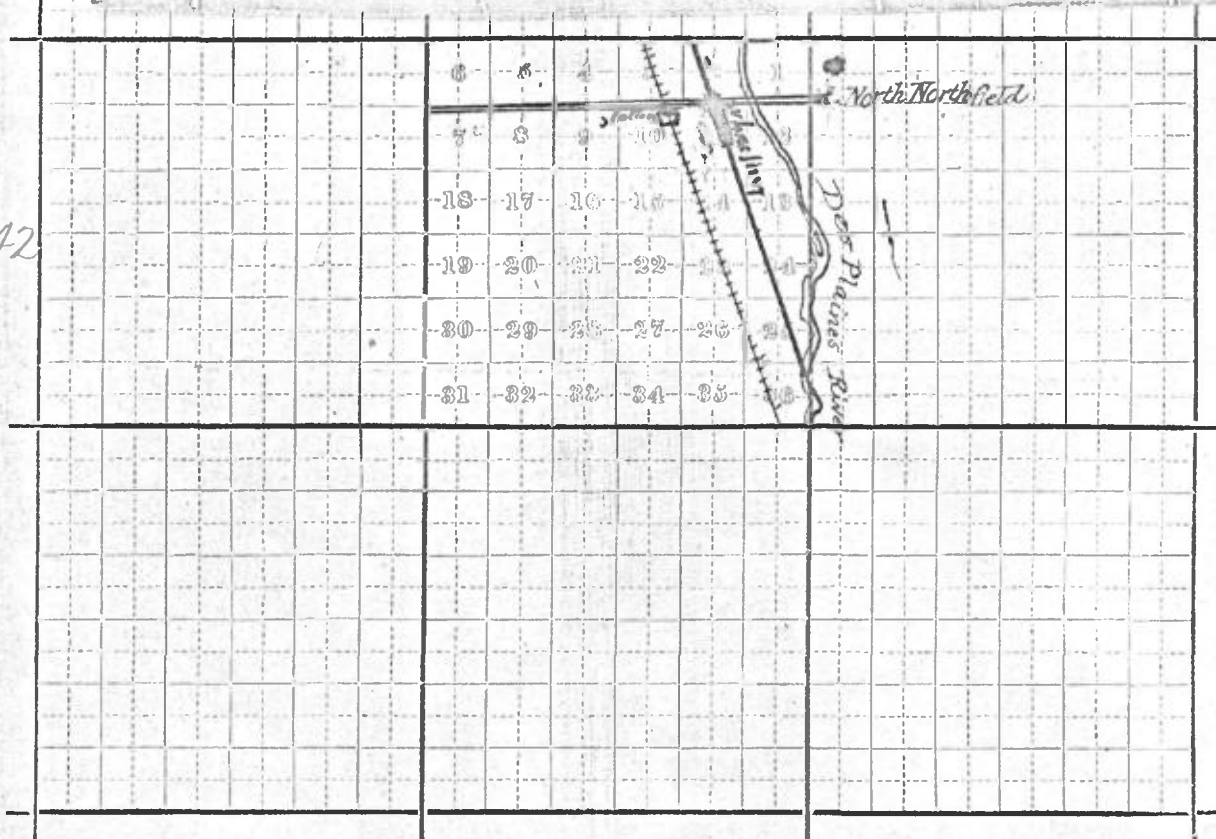

Scale $\frac{1}{4}$ inch to the mile.

(SOUTH.)

5-2342

Is the railroad line correctly located?
 If not, please make necessary corrections.
 Mark site of Wheeling P.O.

DIAGRAM, EXPLANATION, AND INSTRUCTIONS.

Indicate upon the diagram the proposed site of the post office by placing a dot in the proper quarter section.

The surrounding offices and the present site of this office should be accurately located and the names plainly written.

Draw distinctly the railways, roads, rivers, and creeks.

The post office would be situated in the S. ~~SE~~ E. quarter of section No. 2
in Township 42 S., Range 11 E., of the 3 principal meridian.
(N. or S.) (E. or W.)

In localities not surveyed by the U. S. Land Office, a sketch map is requested.

RANGE (No.) (E. or W.) RANGE (No.) (E. or W.) RANGE (No.) (E. or W.)
(NORTH.)

TOWNSHIP

Whitney

(No.) (N. or S.)

TOWNSHIP

(No.) (N. or S.)

TOWNSHIP

(No.) (N. or S.)

11

Scale, one-third inch to the mile.

(SOUTH.)

5-5879

DIVISION OF RURAL MAILS

PROPOSED LOCATION OF POST OFFICE

OFFICE OF FOURTH ASSISTANT
DIVISION OFIN REPLYING
MENTION INITIALS AND DATE

Post Office Department

29 1913

FOURTH ASSISTANT POSTMASTER GENERAL

RURAL MAILS

December 3, 1913.

The Postmaster, 1914

Wheeling, Illinois.

Washington

SIR: With reference to the proposed change in site of the post office named below, and in order that the office, if changed to the proposed location, may be accurately represented upon the post-route maps, it is requested that you furnish accurately the information called for below and prepare a sketch according to instructions on opposite side of paper, which should be returned to this Division as soon as possible.

Respectfully,

WAD

FOURTH ASSISTANT POSTMASTER GENERAL

Post Office, Wheeling,

(Name)

Cook,
(County)

Illinois.

(State)

The name of the post office is

Wheeling Illinois

If the town, village, or site of the post office be known by another name than that of the post office, state that other name

here.

The post office, if changed to the proposed site, would be 25 feet air-line distance, South from its present location.

(N., S., E., or W.)

The post office would be situated in the

S. E.

quarter of section No.

2

in Township

42

(N. or S.)

Range

11 E.

of the

3

principal meridian, County of

Cook

State of

Illinois

The name of the nearest river is

Des Plaines

and the post-office building would be at a

distance of

7.5 Rods

on the

W.

side of it.

(N., S., E., or W.)

The name of the nearest creek is

Buffalo

and the post-office building would be at a

distance of

One mile

on the

E.

side of it.

(N., S., E., or W.)

The name of the nearest office on the same route as this post office is

and its distance is

X

miles, by the traveled road, in a

X

direction from the proposed site of this office.

(N., S., E., or W.)

The name of the nearest office on the same route, on the other side, is

and its distance is

X

miles, in a

(N., S., E., or W.)

direction from the proposed site of this office.

The name of the nearest office not on the same route as this post office is

and its distance is

miles, by the traveled road, in a

(N., S., E., or W.)

direction from the proposed site of this office.

The post-office building would be on the

E.

side of the

Des Plaines

Railroad,

and at a distance of

1 1/8 m.

from the track. The railroad station name is

Wheeling

The post office would be
county boundary.

(N., S., E., or W.)

from the nearest point of my

Signature of Postmaster:

Emil Sigwalt

Date:

Dec 5-1913

McC.

W.

Division of Supplies

DIVISION OF TOPOGRAPHICAL

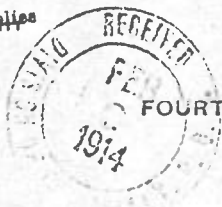

Post Office Department

FOURTH ASSISTANT POSTMASTER GENERAL

Washington

Jan. 27-1914.

SIR:

In order that the site of your post office may be accurately represented upon the post-route maps, it is requested that you carefully answer the questions below and furnish a sketch, according to instructions on opposite side of paper, which should be returned to this Division as soon as possible.

Respectfully,

To Postmaster at Wheeling
Cook Co.
Illinois.

Fourth Assistant Postmaster General.

The name of my post office is Wheeling Illinois

If the town, village, or site of the post office be known by another name than that of the post office, state that other name here: Town & Village are both named Wheeling

My post office is situated in the S.W. quarter of section No. 1, in Township N. 42

Range N. E of the 39 principal meridian, County of Cook

State of Illin

The name of the nearest river is Des Plaines, and the post-office building is at a distance of 1000 feet on the W side of it.

The name of the nearest creek is Buffalo, and the post-office building is at a distance of _____ on the _____ side of it.

The name of the nearest office on my route is _____ and its distance is _____ miles, by the traveled road, in a _____ direction from this, my office.

The name of the nearest office on my route, on the other side, is _____ and its distance is _____ miles, in a _____ direction from this, my office.

The name of the nearest office not on my route is _____ and its distance is _____ miles, by the traveled road, in a _____ direction from this, my office.

The post-office building is on the East side of the Soo Rail R. Railroad, and at a distance of 1 1/4 m. from the track.

The railroad station name is Wheeling

My post office is 1 1/4 mil, air-line distance, S from the nearest point of my country boundary.

Postmaster:

Emil Sigwalt

Date: Feb 7-1914

USE ONLY THE DIAGRAM THAT IS APPLICABLE TO YOUR LOCALITY

CIRCLE: for *unsectionized* country. SQUARE: for sectionized land

DIRECTIONS

In the circle, let the dot represent your post office,

or

In the square, place a dot representing your post office in the proper quarter section;

then

Draw the following features, if within the area of the diagram, in proper relation to your post office:

Adjacent post offices (show with dot);

Railroads (show by line with cross-marks);

Main highways (name and show on margin name of town to which each road leads);

Rivers and creeks;

County line (show by dashes).

Letter the name on each item shown on the sketch.

Be careful to show each feature distinctly and draw according to the scale given under the diagram being used.

If a map of your town is available and can be furnished without expense, it should be marked with the location of your post office and forwarded for the files of the Division of Topography.

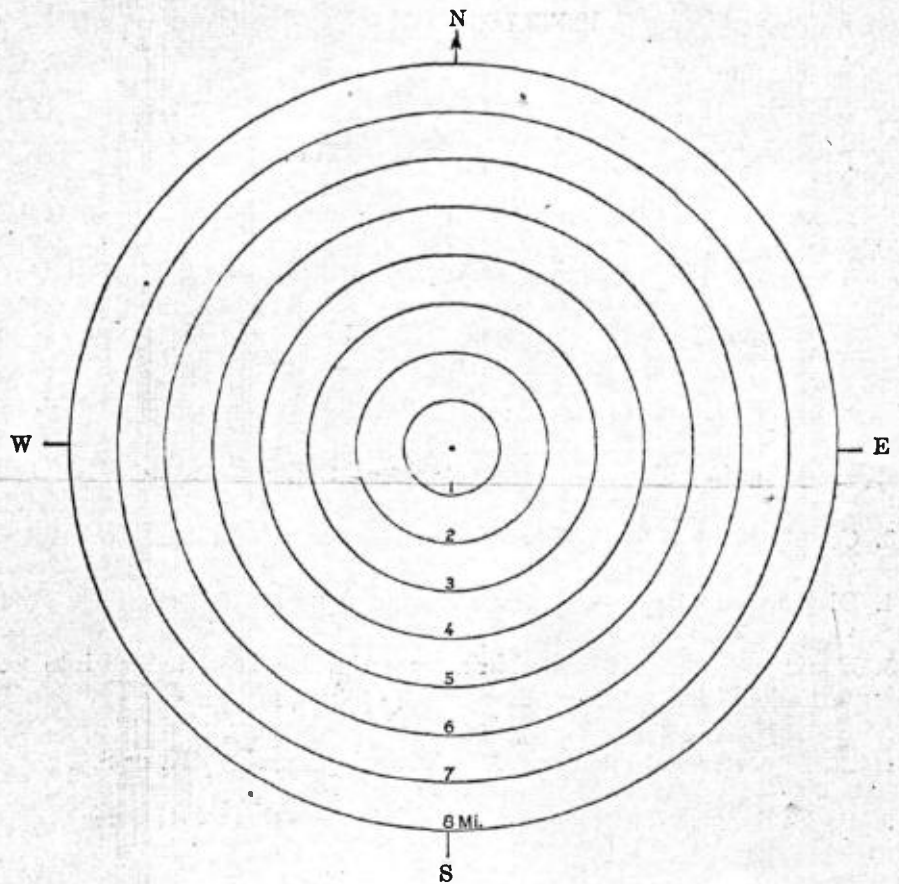

Range _____ E. or W. _____
N

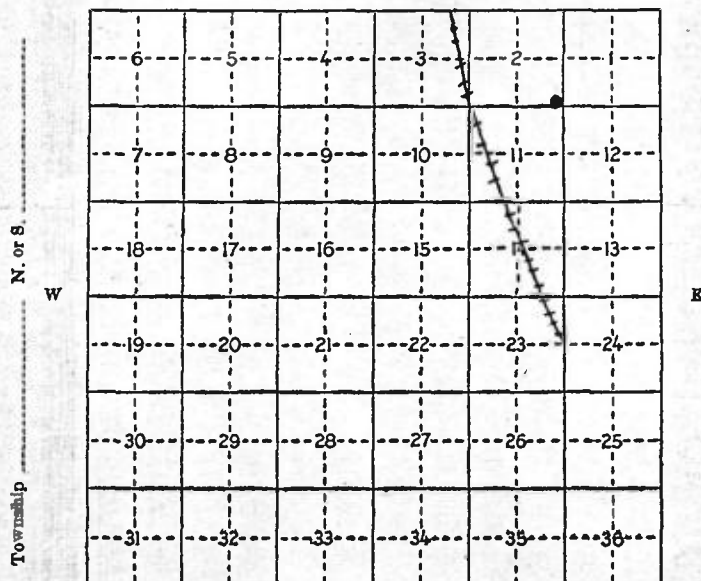

Scale: 1/4 inch equals 1 mile

Release Deed

Christian Wilflin

TO

John Birk

State of Ill }
Cook County. } SS. No 2515720

This instrument was filed for record in the Recorder's
Office of Cook County aforesaid, on the
29 day of mch
A. D. 1897, at 11 o'clock a M. and
recorded in Book 5389 of Recorder
on page 21

Robert M. Simon
Recorder.



Know all Men by these Presents, That

Christian Welflin

of the County of Cook and State of Illinois for and in consideration of one dollar, and for other good and valuable considerations, the receipt whereof is hereby confessed, do hereby remise, convey, release and quit-claim unto

John Burk of the County of Cook and State of Illinois all the right, title, interest, claim, or demand, whatsoever,

I may have acquired in, through or by a certain Mortgage Deed, bearing date the First day of September A. D. 1891, and recorded in the Recorder's office of Cook County, in the State of Illinois, in Book 3410 of Records page 349, to

the premises therein described, as follows, to-wit: Being Lot No twenty six (26) lying and being forty (40) feet on Milwaukee Road by one hundred and eighty (180) feet deep as marked, plated and Recorded in the Recorder's Office of said Cook County J L McDuffie in Book of plats No (49) and lying in the west half of the North West quarter of Section twelve (12) T (42) R (11) East of the Third Principal Meridian

situated in the Village of Wheeling County of Cook and State of Illinois, together with all the appurtenances and privileges thereunto belonging or appertaining.

Witness my hand and seal, this twenty third day of March A. D. 1897

Christian Welflin

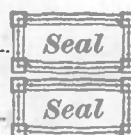

State of Illinois } ss.
Cook COUNTY.

I, Jacob Fritsch

in and for the said County, in the State aforesaid, DO HEREBY CERTIFY, that

Christian Welflin

personally known to me to be the same person whose name is subscribed to the foregoing Instrument, appeared before me this day in person, and acknowledged that he signed, sealed and delivered the said Instrument as his free and voluntary act, for the uses and purposes therein set forth.

Given under my hand and Notarial seal, this

27th day of March A. D. 1897

Jacob Fritsch
Notary



The Grantor, s John Birk and Elizabeth Birk his wife

of the town of Wheeling in the County of Cook
and State of Illinois for and in consideration of

Four Hundred and fifty

Dollars in hand paid, CO. VEE.... and WARRANT.... to

Margarette Baumann

of the town of Wheeling County of Cook
and State of Illinois the following described real estate, to wit:

Lot twenty six (26) lying and being forty (40)
feet on the Milwaukee road by one hundred
and eighty (180) feet deep, as marked, platted
and recorded in the recorder's office of said
county of Cook, by J. L. McDuffel in Cook
of plat 49 and lying in the west half of the
north west quarter of section twelve (12) township
forty two (42) range eleven (11)

situated in the County of Cook in the State of Illinois, hereby
releasing and waiving all rights under and by virtue of the Homestead Exemption Laws of this State.

Subject to a mortgage to be held for the sum of Seventy
five dollars which the grantor herein assumes and agrees to pay

Dated this twenty eighth day of April A. D. 1893,

Signed, Sealed and Delivered in Presence of

John Birk
Elizabeth Birk



STATE OF ILLINOIS,

book

COUNTY.

SS.

I, William H. Dutton, a Notary Public,

in and for the said County, in the State aforesaid, do hereby certify that John Birk and Elizabeth Birk his wife who are

personally known to me to be the same person whose names are subscribed to the foregoing instrument, appeared before me this day in person and acknowledged that They signed, sealed and delivered the said instrument as their free and voluntary act, for the uses and purposes therein set forth, including the release and waiver of the right of homestead.

Given under my hand and Notarial seal, this 28th day of April A. D. 1893.

William H. Dutton

Notary Public



WARRANTY DEED.

John Birk

TO

Mary Jane the Bannerman

STATE OF ILLINOIS, 8th Mo. 1893.

Grant County,

This instrument was filed for record on the 2 day of May A. D. 1893 at 2 o'clock P. M., and duly recorded in book 4314 of

Records on page 126

Paul J. Behar

Recorder.

By

John A. Morris Company, Printers and Manufacturing Stationers, Chicago.

Return to W. H. Dutton

This Indenture Witnesseth, that the Mortgagor:

John Birk and Elizabeth Birk his wife
of the Town of Wheeling in the County of Cook and State
of Illinois Mortgage and Warrant to Christian Willin

of the Town of Wheeling
County of Cook and State of Illinois to secure the payment of
certain promissory note, executed by John Birk
bearing even date herewith, payable to the order of Christian Willin

for the sum of Seventy five Dollars with interest at
six per cent per annum payable annually and due
in three years after date

the following described real estate, to-wit: Being Lot No Twenty six (26) lying and
being Forty (40) feet on Milwaukee Road by One Hundred
and Eighty (180) feet deep as marked plotted and recorded
in the Recorder's Office of said County of Cook by
J. L. McDuffie in Book of plats No Forty nine (49)
and being the West half of the North West quarter
of Section twelve (12) Township Forty two (42) Range
Eleven (11) East of the Third Principal Meridian

situated in the County of Cook in the State of Illinois, hereby releasing and waiving all
rights under and by virtue of the Homestead exemption Laws of the State of Illinois, and all right to retain poss-
ession of said premises after any default in payment or breach of any of the covenants or agreements herein
contained.

But it is Expressly Provided and Agreed, That if default be made in the payment of the said
One promissory note, or of any part thereof, or the interest thereon, or
any part thereof, at the time and in the manner above specified for the payment thereof, or in case of waste
or non-payment of taxes or assessments on said premises, or a breach of any of the covenants or agreements
herein contained, then and in such case the whole of said principle sum and interest, secured by the said

One promissory note in this mortgage mentioned, shall thereupon, at the option
of the said mortgagee his heirs, executors, administrators, attorneys or assigns, become im-
mediately due and payable: And this mortgage may be immediately foreclosed to pay the same by said
mortgagee his heirs, executors, administrator attorneys or assigns; And it shall be lawful for
the said mortgagee his heirs, executors, administrators, attorneys or assigns, to enter into and upon the
premises hereby granted, or any part thereof, and to receive and collect all rents, issues and profits thereof.

Upon the Filing of any Bill To foreclose this mortgage in any court having jurisdiction thereof
such court may appoint any attorney or any proper person
receiver, with power to collect the rents, issues and profits arising out of said premises during the pendency
of such foreclosure suit, and until the time to redeem the same from any sale that may be made under any
decree foreclosing this mortgage shall expire; and such rents, issues and profits when collected may be applied
toward the payment of the indebtedness and costs herein mentioned and described. And upon the foreclosure
and sale of said premises, there shall be first paid out of the proceeds of such sale all expenses of advertise-
ment, selling and conveying said premises, and Fifty dollars attorney's or solicitor's fees,
to be included in the decree, and all moneys advanced for taxes, assessment and other liens: then there shall
be paid the principle of said note whether due and payable by the terms thereof or not, and the interest thereon.

Dated, This First day of September A. D. 1891

John Birk

SEAL

Elizabeth Birk

SEAL

SEAL

State of Illinois }
COUNTY OF Cook } ss.

I, Jacob Fritsch

Notary Public in and for said County, in the
State aforesaid, DO HEREBY CERTIFY that John Birk
and Elizabeth his wife

personally known to me to be the same persons whose names
subscribed to the foregoing instrument, appeared before me this day in
person, and acknowledged that he signed, sealed and delivered the
said instrument as their free and voluntary act, for the uses and
purposes therein set forth, including the release and waiver of the right
of homestead.

GIVEN under my hand and Notarial seal
this 1st day of September A. D. 1891

Jacob Fritsch
Notary Public

REAL ESTATE MORTGAGE

STATUTORY FORM.

John Birk

TO—
Christian Woffles

State of Ill. }
Cook County, } 1530945

This Instrument was filed for record in
the Recorder's office of Cook County
aforesaid, on the 1st day
of September A. D. 1891 at 11
o'clock A. M., and recorded in Book 340
of Records on page 349
John Stephens
Recorder.

8

Know all Men by these Presents, That
Christian Welflin

of the County of Cook and State of Illinois for and in
 consideration of one dollar, and for other good and valuable considerations, the receipt whereof is
 hereby confessed, do hereby remise, convey, release and quit-claim unto

John Burk
 of the County of Cook and
 State of Illinois all the right, title, interest, claim, or demand, whatsoever,
I may have acquired in, through or by a certain Mortgage Deed,
 bearing date the First day of September A. D. 1891, and
 recorded in the Recorder's office of Cook County, in the State
 of Illinois, in Book 3410 of Records page 349, to

the premises therein described, as follows, to-wit: Being Lot No twenty six
(26) lying and being Forty (40) feet on Milwaukee
Road by one hundred and Eighty (180) feet deep
as marked plotted and Recorded in the Recorder's
Office of said Cook County J L McDuffie in
Book of plats No (49) and lying in the west
half of the North West quarter of Section twelve
(12) T (42) R (11) East of the Third Principal
Meridian

situated in the Village of Wheeling County of Cook
 and State of Illinois, together with all the appurtenances and privileges
 thereunto belonging or appertaining.

Witness my hand and seal, this twenty third day
 of March A. D. 1897

Christian Welflin

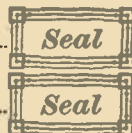

State of Illinois } ss.
Cook COUNTY.

I, Jacob Fritsch

in and for the said County, in the State aforesaid, DO HEREBY CERTIFY, that

Christian Welflin

personally known to me to be the same person whose name is subscribed to the
 foregoing Instrument, appeared before me this day in person, and acknowledged that he signed,
 sealed and delivered the said Instrument as his free and voluntary act, for the uses
 and purposes therein set forth.

Given under my hand and Notarial seal, this

27th day of March A. D. 1897
Jacob Fritsch
Notary

Release Deed

Christian Wilflin

TO

John Birk

State of *Ill* }
Cook County. } ss. No. **2515720**

This Instrument was filed for record in the Recorder's
Office of *Cook* County aforesaid, on the
24 day of *mch*
A. D. 189*7*, at *11* o'clock *a* M. and
recorded in Book *5389* of *Records*
on page *21*

Robert M. Simon
Recorder.

Yourself and company are cordially invited

TO ATTEND THE

FOURTH GRAND RECEPTION

GIVEN BY THE

UNIQUE PLEASURE CLUB

AT WELFLIN'S HALL - WHEELING, ILLINOIS

Saturday Evening, December 30, 1893.

GRAND ENTREE AT 9 O'CLOCK SHARP.

TRAINS LEAVE WISCONSIN CENTRAL DEPOT, CHICAGO, 3.45 AND 5.00 P. M.

RECEPTION COMMITTEE.

H. G. WHITING.

J. METHLING. ✓

F. C. HABEN. ✓

A. MILLER.

G. H. PERIOLAT.

FLOOR COMMITTEE.

J. A. HABEN. ✓

C. A. ARMBRUSTER. ✓

E. C. HABEN. ✓

J. W. WELLS.

68D-3-2

Subject,

Acceptance of ordinance.

CHICAGO TELEPHONE CO.

TELEPHONE BUILDING 203 WASHINGTON ST.

Chicago, Ill.

Sept. 11, 1900.

Mr. Reinhold Schneider, Village Clerk,

Wheeling, Illinois.

Dear Sir:

I enclose to you herewith acceptance of this company of the ordinance passed for us on the third instant, by the President and Board of Trustees of your Village, which has been signed by our President. Enclosed with it is also a copy of same, together with a form of acknowledgement of its receipt by you. Will you kindly sign and return to me for our records, the copy herewith?

Yours truly,

W. R. Abbott

Acting Superintendent.



Subject,

Application for franchise.

CHICAGO TELEPHONE CO.

TELEPHONE BUILDING 203 WASHINGTON ST.

Chicago, Ill.

August 23, 1900.

To The Honorable The President,

And Board of Trustees,

Wheeling, Illinois.

Gentlemen:

Permit me to submit for your consideration, application of the Chicago Telephone Company for an ordinance permitting it to build and maintain telephone lines in your village, to meet the demands for such service from your citizens.

Your early consideration of this matter will be appreciated.

Respectfully,

CHICAGO TELEPHONE COMPANY,

By

A. P. Sullivan

Acting Superintendent.

Subject,

Acceptance of Ordinance.

CHICAGO TELEPHONE CO.

TELEPHONE BUILDING, 203 WASHINGTON ST.

Chicago, Ill. September 12, 1900.

To the President and Board of Trustees,

Village of Wheeling, Illinois.

Mr. Reinhold Schneider, Village Clerk.

Gentlemen:

The Chicago Telephone Company hereby presents its written and unconditional acceptance of the provisions of an ordinance tendered to it by passage and approval of the President and Board of Trustees of the Village of Wheeling, September third, 1900, and requests that this acceptance be filed in the office of the Village Clerk, as provided in SECTION FOUR of the ordinance.

Very respectfully,

CHICAGO TELEPHONE COMPANY,

By

John M. Clark.

President.

ATTEST:

C. E. Moolay
Secretary.

(Kuss)

There were negatives & pieces of glass
on glass which were
destroyed in basement flood 1993.
The glass was thrown out

LLR June
1999

35

NO 17.

Name W. A. Munnick

Remarks Healing, etc.

Sept. 1900

a